

Alex Bagger. 1990.

ARCHITECTURE OF
ROME

A NINETEENTH-CENTURY
ITINERARY BY

Giovanni Battista Cipriani

INTRODUCTION BY
Stanley Tigerman



Sepulchre of St. Vibius Marcinus

RIZZOLI

NEW YORK · 1986

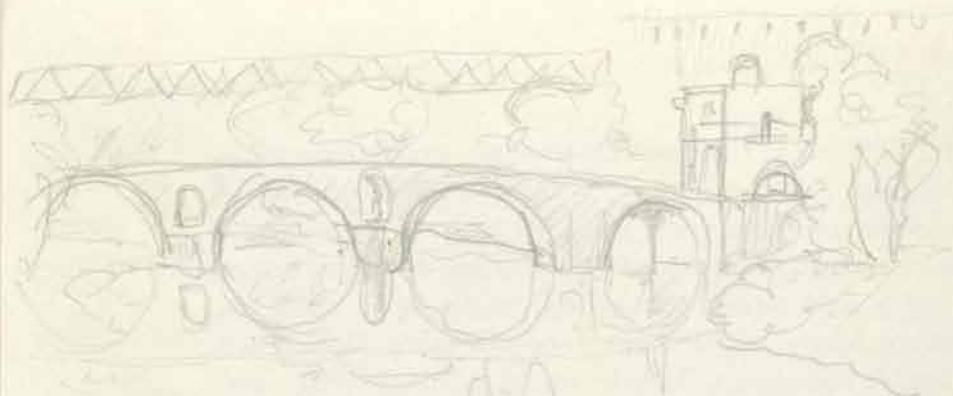

ist nicht durch
Lunge Tevere
& scheint her zu kommen



PRIMA GIORNATA

Ponte Milvio d. Nello



Tab. con. 1. 1774



Tabernacolo
del S. Andrea

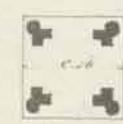

Tab. con. 1. 1774

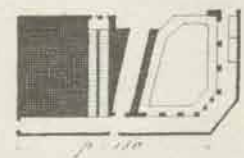

Cassina
della Piazza Giulia
architetto Pandolfo Pignatelli 1774



Chiesa di S. Andrea
architetto Pignatelli 1774

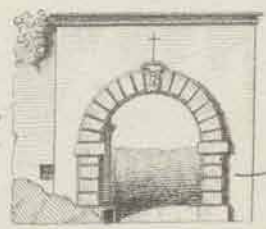

Arco
Giulio

idealisiert

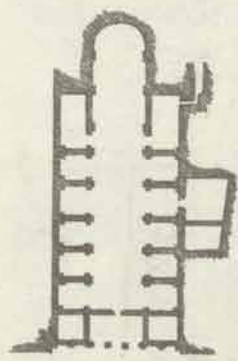

*S. Lorenzo in Lucina
Cassina da Bragaglia 1870.*

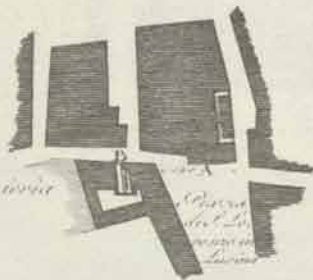

*A
Casamento e Spazzaria
Mauri*

*B
Modificazioni
dell'Altare*



A



*S. Silvestro
1704 di*

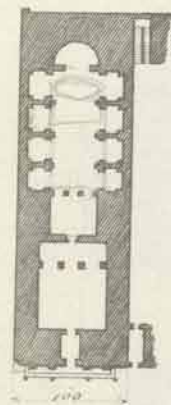

*in Capite
Gio. de' Rossi 1690.*

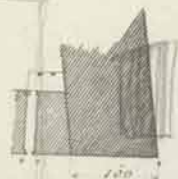

*Casamento
Hofen
Joh. Knapp 1833
und*



poetisch ist doch etwas das jeder
stellt, aber auch für alle ein
Geheimnis birgt, eine Basis zwischen Menschen



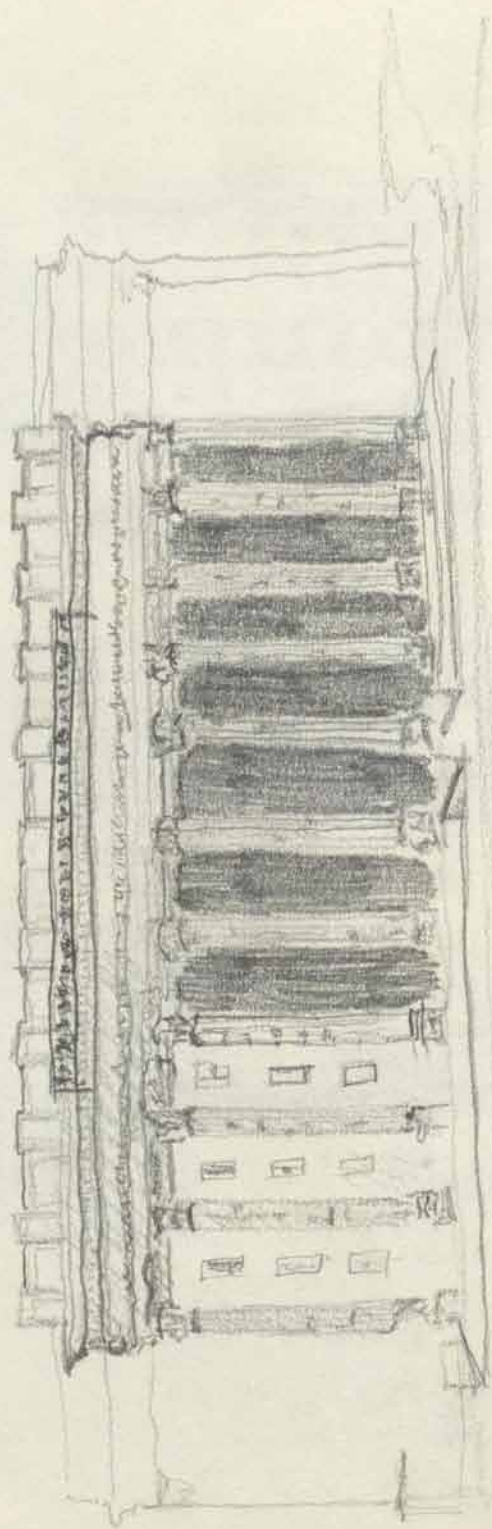

*M. Citorio e Curia Innocenziana
Arch. del Bernini 1650.*

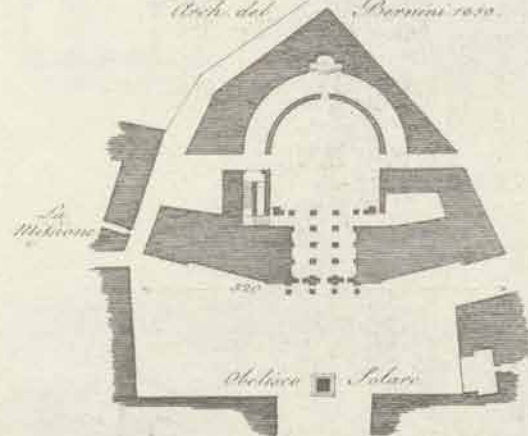

Tempio d' di Antonino - Dogana di terra - 1655.





La Piana
Sopra
MINERVA
Templ

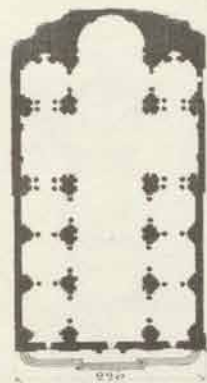

S. Ignazio
Algarotti 1750



Collegio Romano. — B. Ammannati 1582.

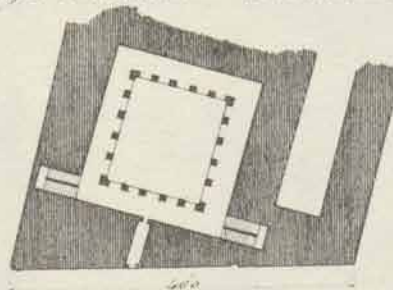

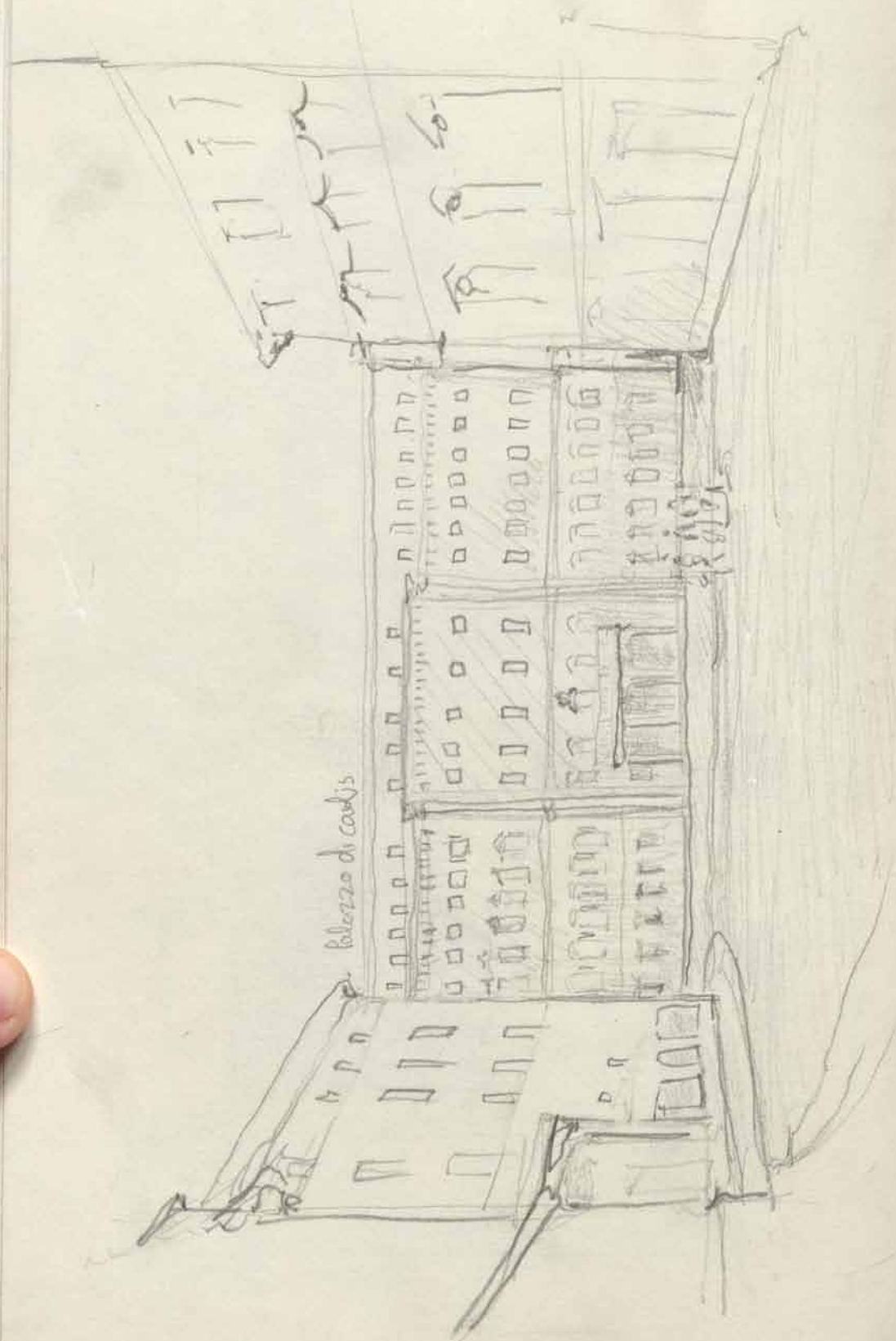

Palazzo Pombino
Arch. di. Alb. Specchi e sono.

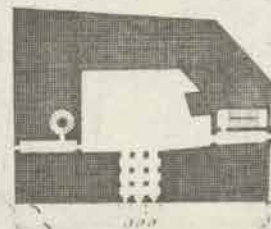

Ensemble
mtl S. Marcello



Palazzo Doria
Arch. di. Valadier e sono.



Ich denke, daß diese 10 würdevollen Schritte zur Erde hin
 viel zur inneren Form von S. Marco beiträgt, die Ein-
 tretenden werden der alltäglichen Sphäre entrückt, die
 Decke hebt sich beim Eintreten und nimmt die
 herabsteigenden in ^{seinen} Bauch auf. ^{der Kirchen-}
 Raum

Ecke des Palazzo Altieri



Palaz. Torlonia
 arch. di G. Fontana
 v. 1860

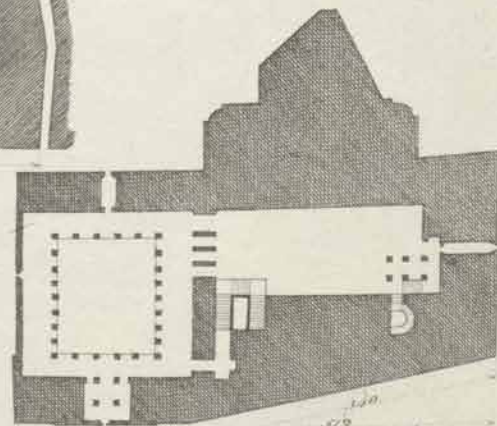
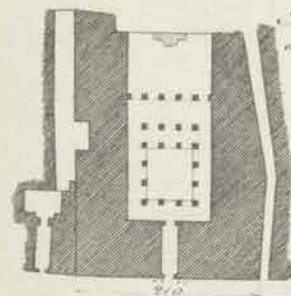

Palaz. Altieri 1772 Arch. des. L. de' Nobili 1870

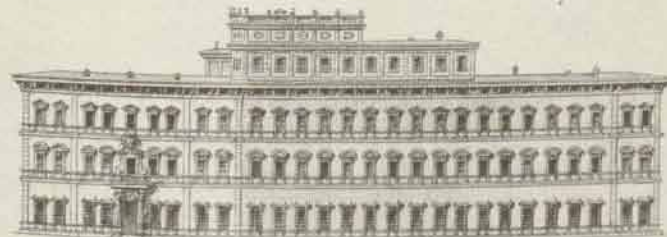

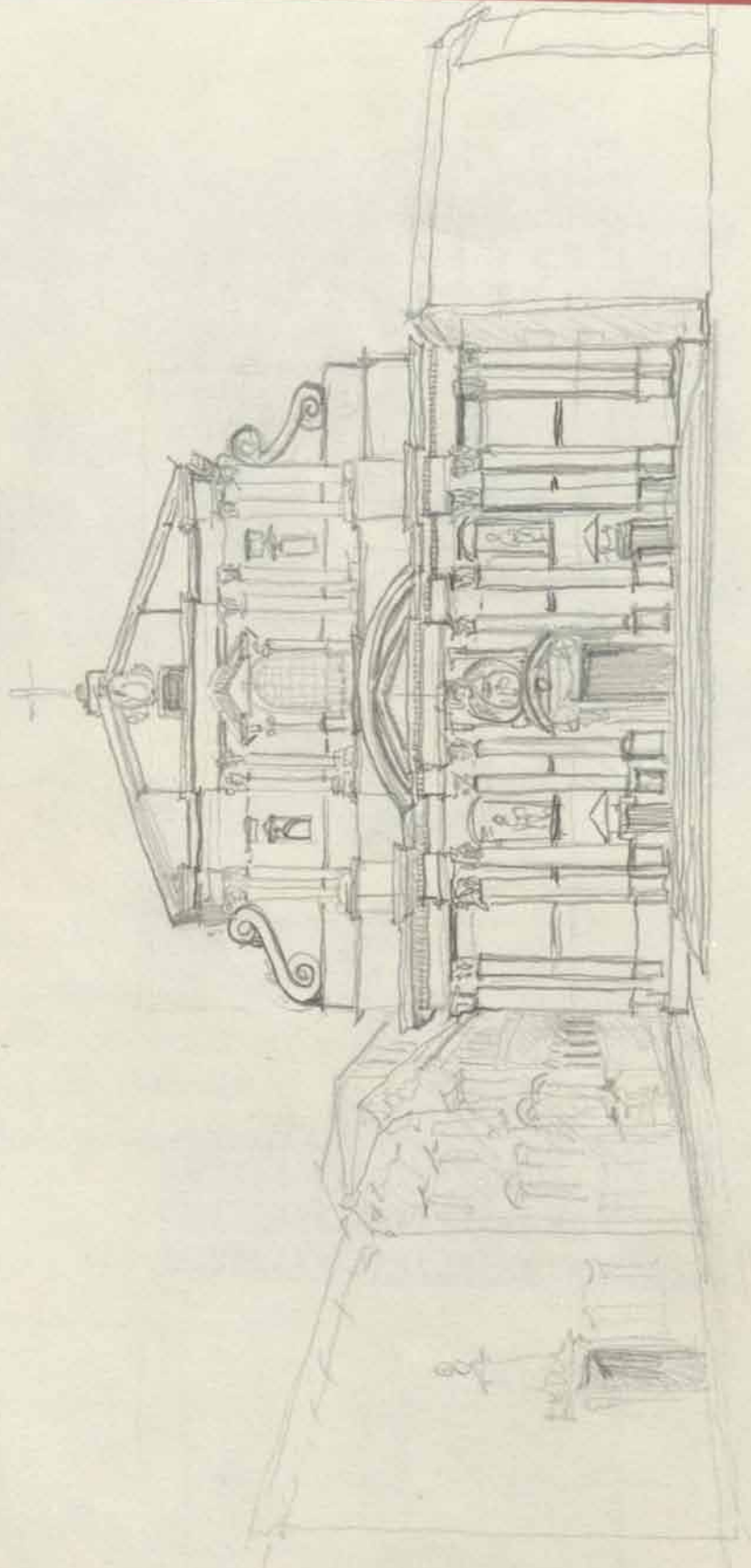

Palazzo Spaziosi
di Camillo Mariani
1867



Chiesa di Santa Maria della Vittoria
1872

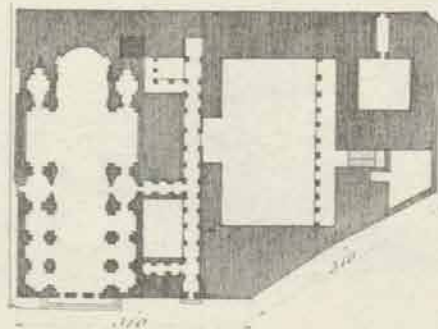



Der vereiste Winterbrunnen
im Schloß von Rom.
(Nathalagewingen)

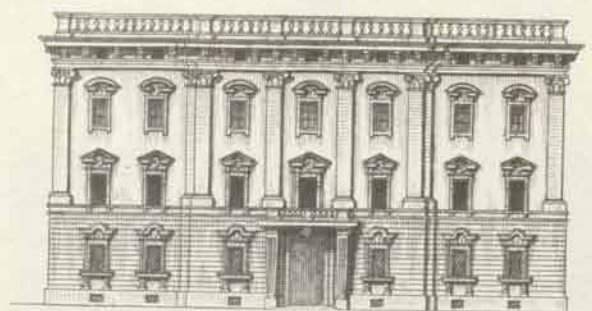

Palazzo Bolognelli
del Card. Fagnoli v. 1732.

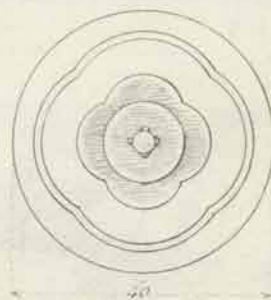

Font. "avanti" Campidoglio

di Giac. della Porta
1562.

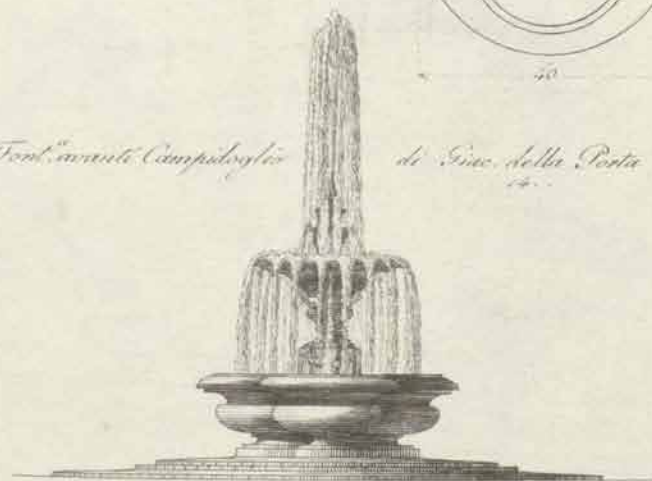

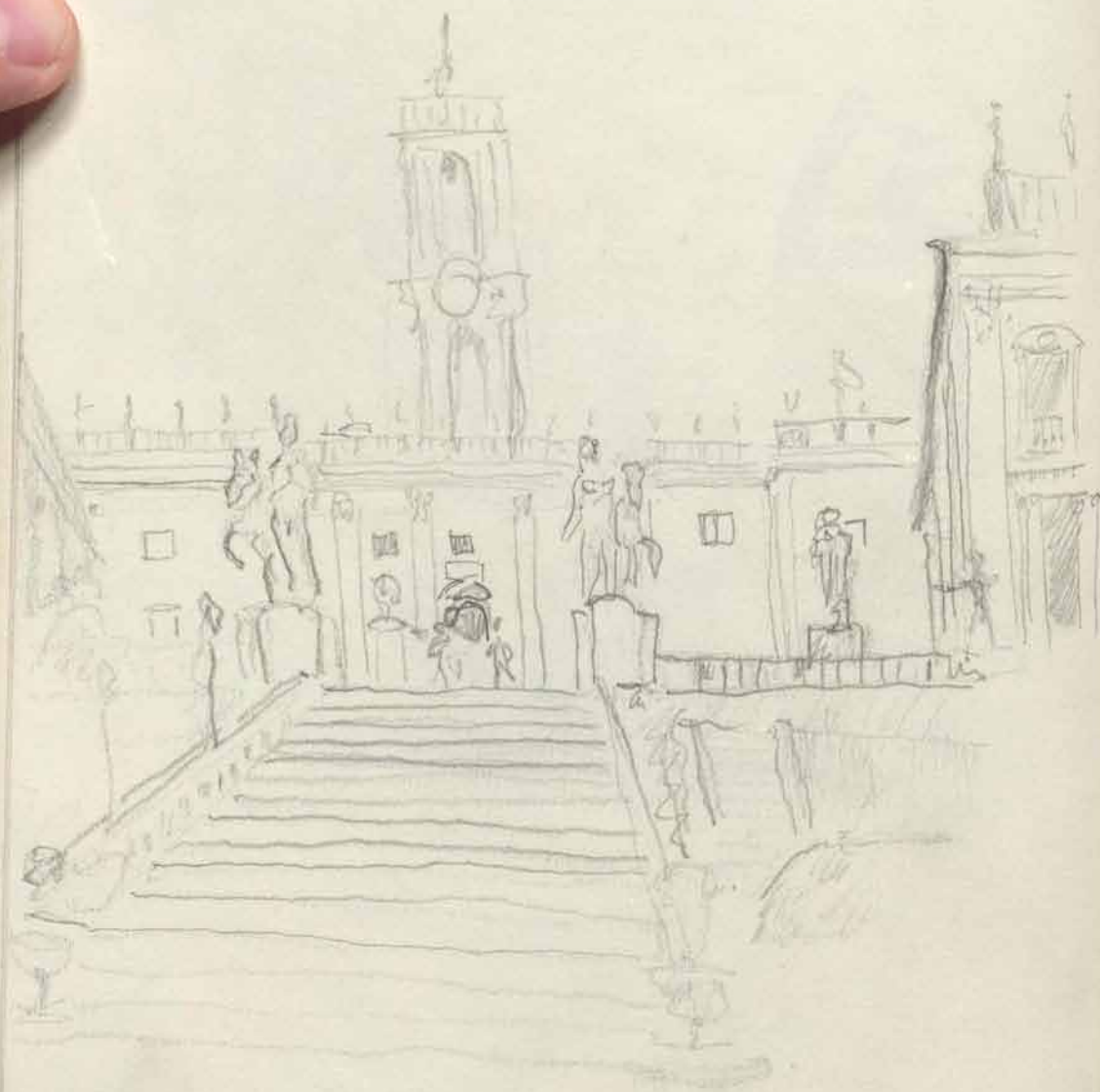

Campidoglio
Palazzo Senatorio
1640

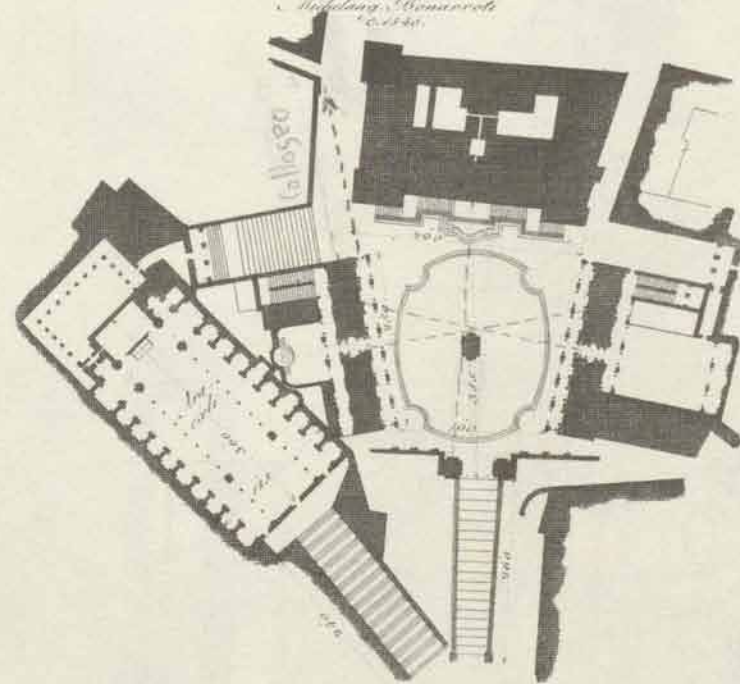

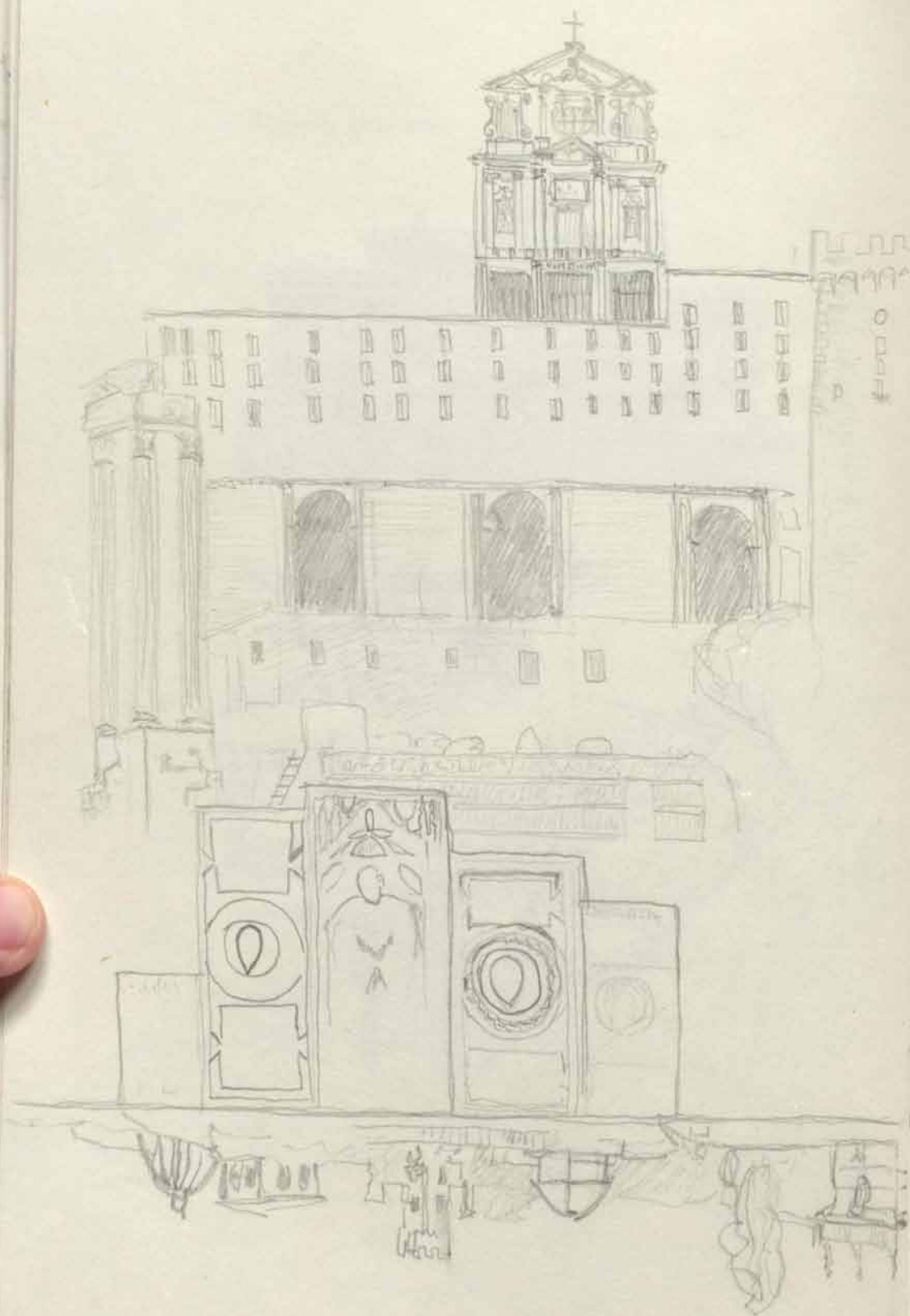

Araceli



*L'Inghilterra di
salvatore
Gio. Batt.*

21

Parte del Foro romano

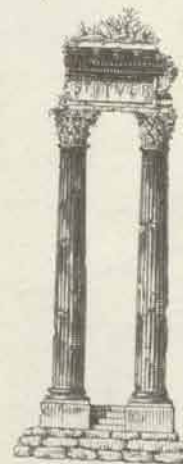
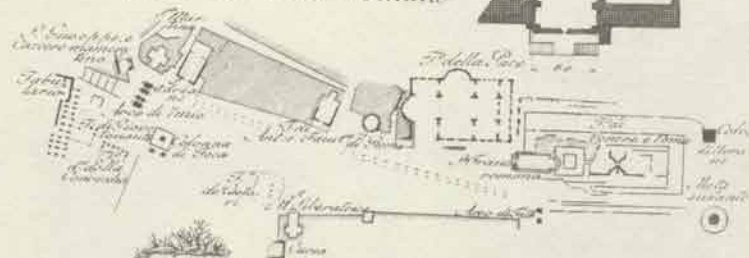

T. di Giove tonante

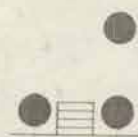

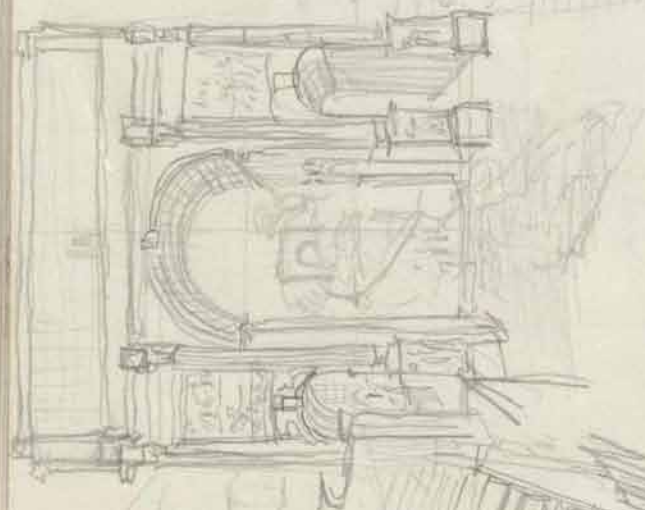

Tempio della Concordia



*Arco di Settimio Severo
circa l'an. 200*



P. de l'antiquité - 1780

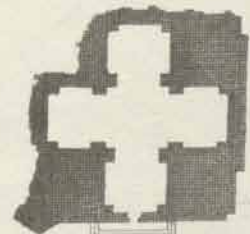
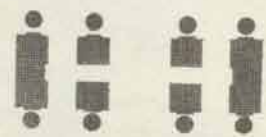



*Civita
Castellana*

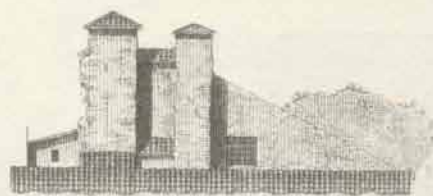

*T. di Viterbo
S. S. Spirito
S. Teodoro*

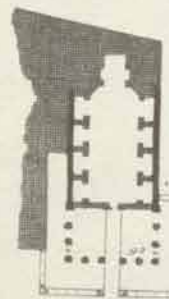

*T. di
Antonino
e Faustina
S. S. Spirito
S. Teodoro
S. S. Spirito
S. Teodoro
1603*



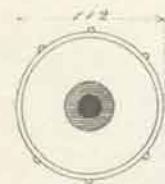
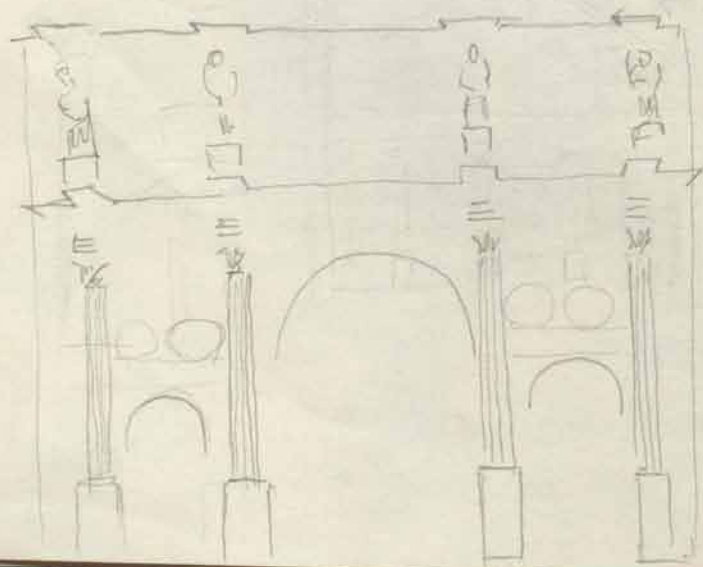

21

Nota sulante

*Anfiteatro Flavio
della
Colosseo
c. il 72.*

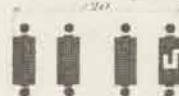

*Arco di Costantino
c. il 312.*



Le tre Cappelle

L'Innocenzo

La S. M. Maria della Pace 1683.

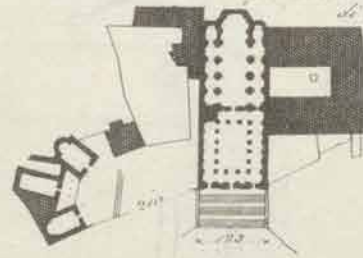

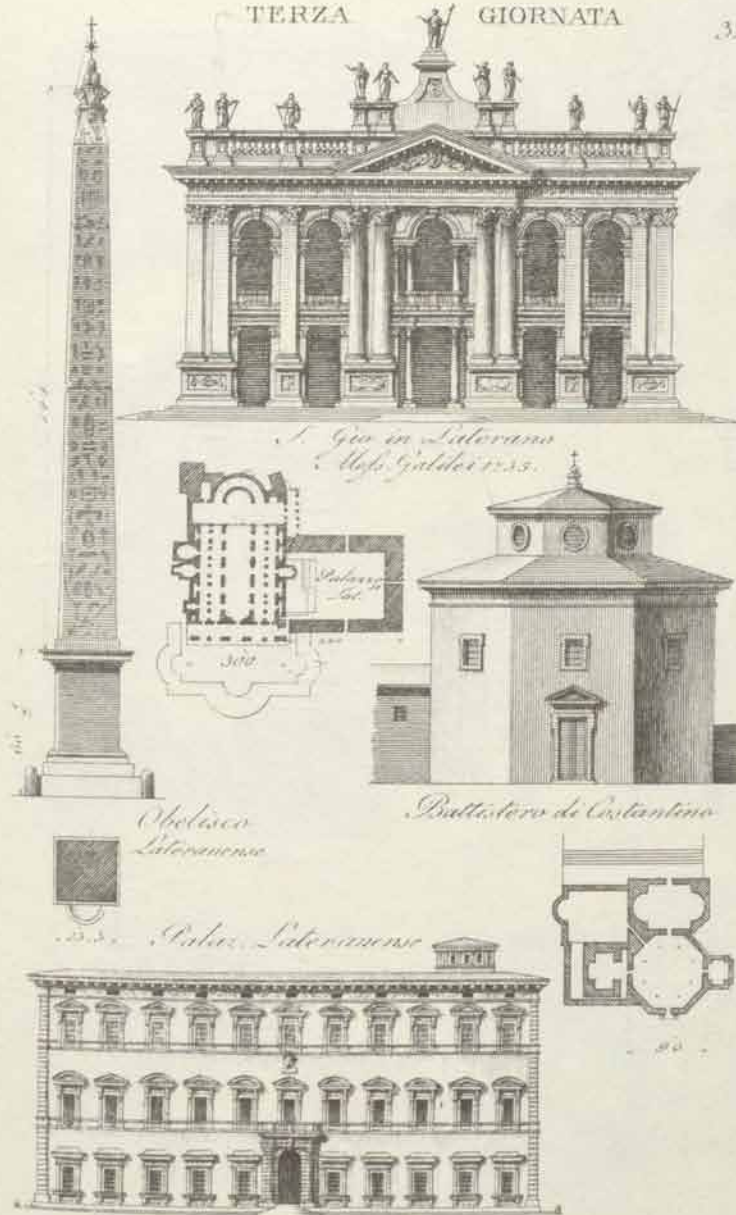

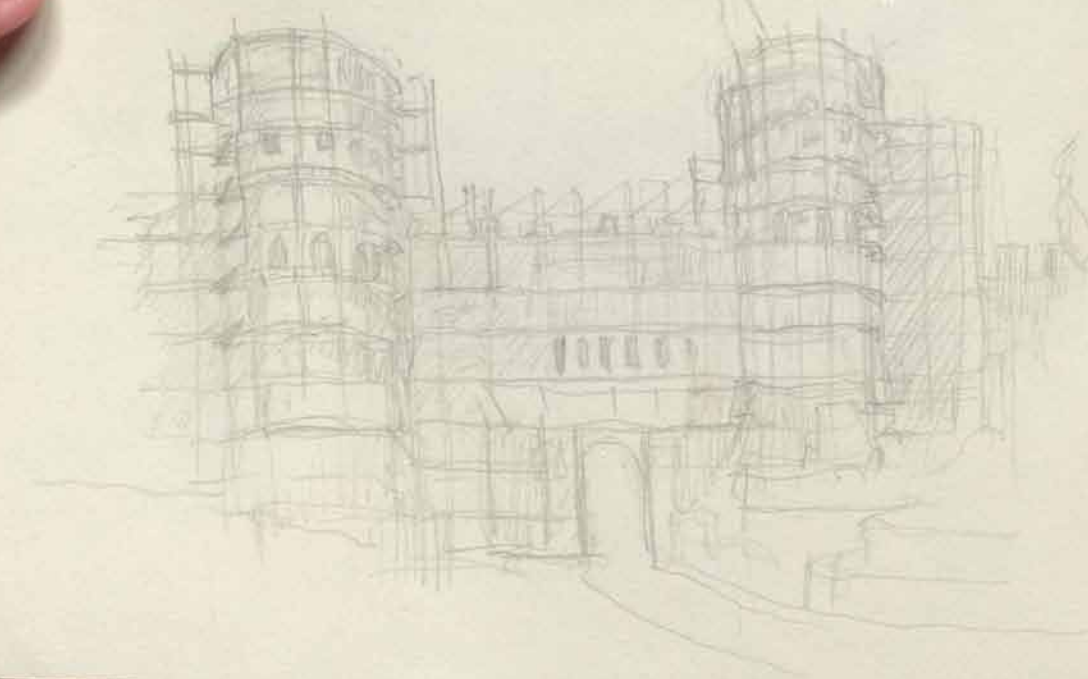

*Scala
Santa
Dom. Fontana
1586*

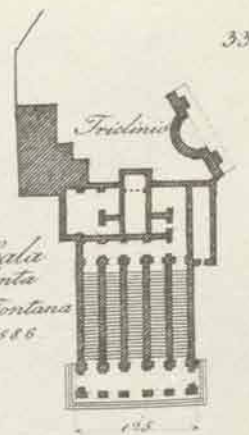

*Fredrico del Leone
Cav. Fuga 1755*



Antica Porta Asinaria



*Porta S. Giovanni
Fino della Porta 1575*



*Tempio
della Fortuna
militare*

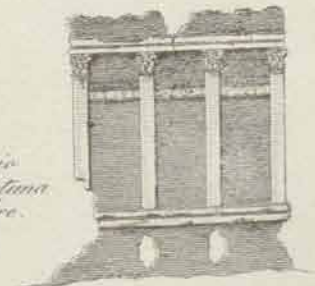

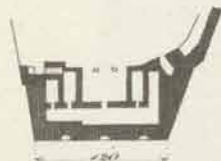

Trofei di Mario



*S. Bibiana.
Car. Bernini 1625.*

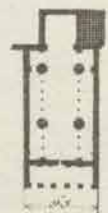
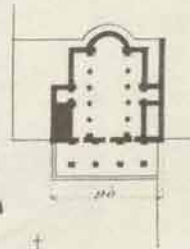

*S. Eusebio.
Nic. Piccini 1750.*





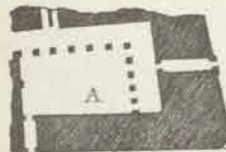

A.A. *Palaz. Albani. Dom. Fontana.*
 B.B. *S. Carlo. F. Borromini 1640.*
 C.C. *Le Sagramentale.*
 D. *S. Andrea. L. Bernini 1671.*



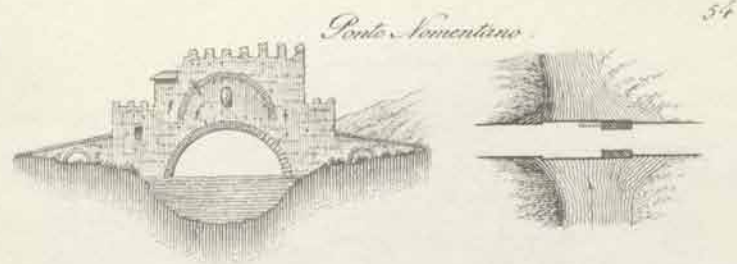

Casino della Villa Albani — Card. Alopi. Albani del. 1760.





Palaz. Barberini

*dis. del. Moderno
Baronini &
Borromini
c. 1630.*



*Chiesa Cappuccini
Aut. Colonna
c. 1635.*

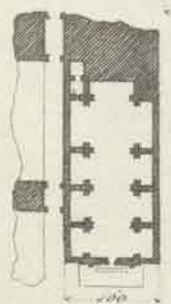
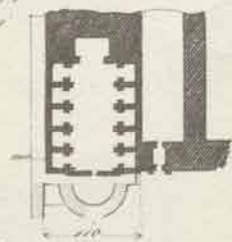
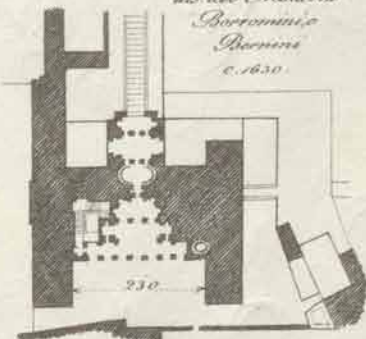

*S. Nicola
de Tolentino
G.B. Borrelli
1664.*





Fontane nella
Piazza Barberini
dis. del cav. Bernini

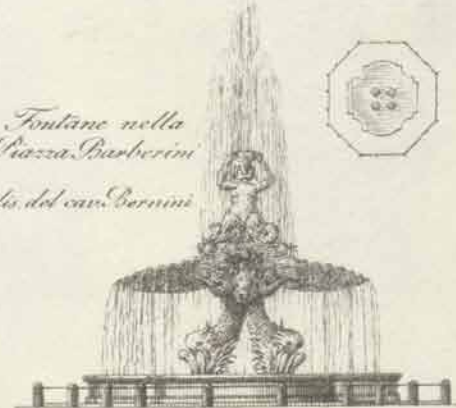

Fontane



S. Andrea.
Aut. Cavoni 1692.





Fontana di Trevi. Nicola Salvi 1735.



*S. Vincenzo ed Anastasio.
Martino Longhi
1630.*



*S. M. in Trivio.
Giac. del Duca
1640.*

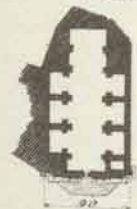

*Acquedotto dell'acqua Vergine.
ref. da Claudio imp.*

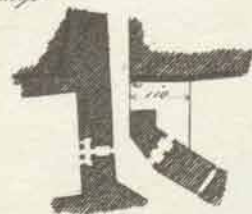

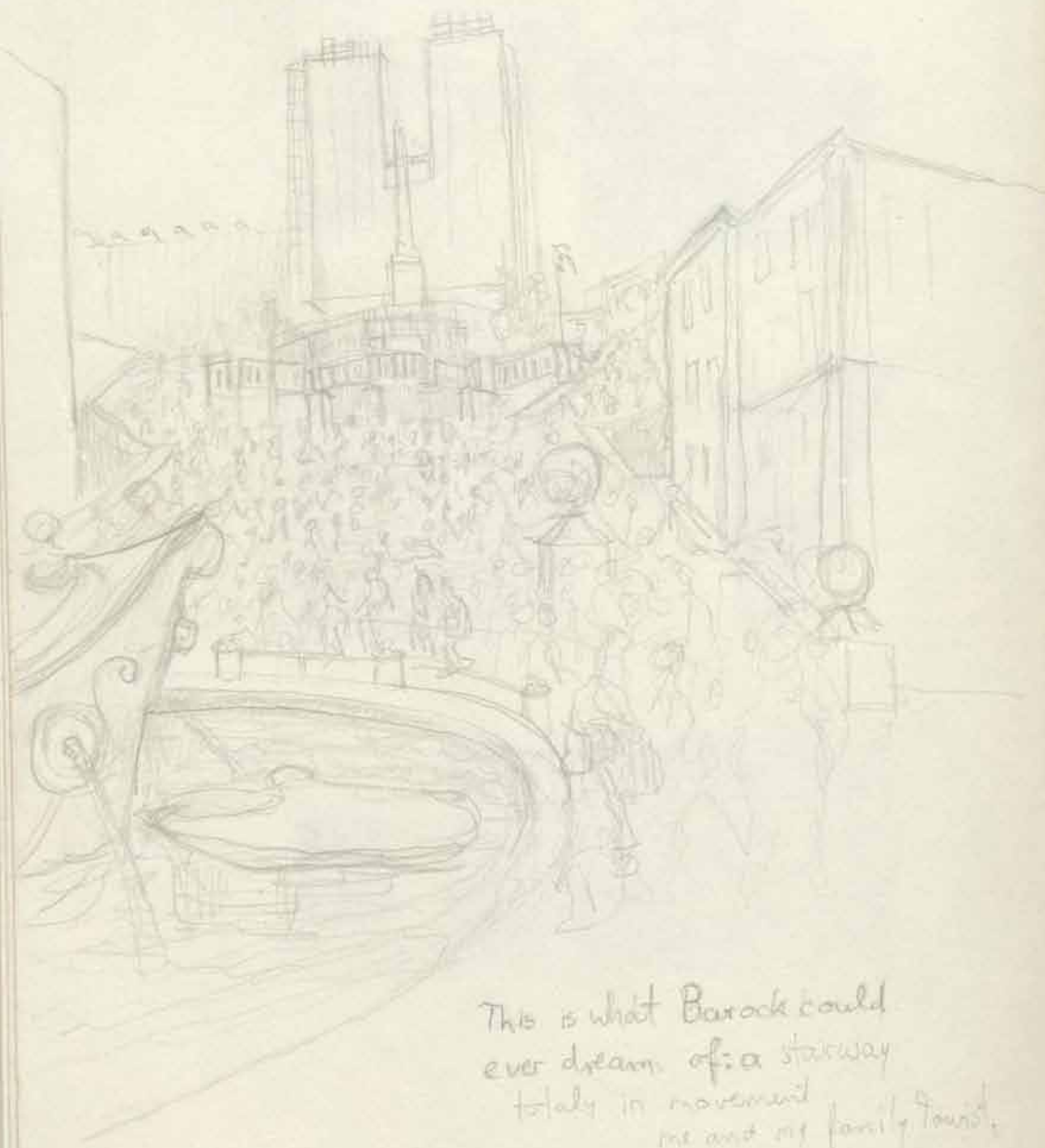

This is what Baroque could
 ever dream of: a stairway
 totally in movement
 me and my family found.



Palaz. Magnanelli



Locanda d. la grand'Europa

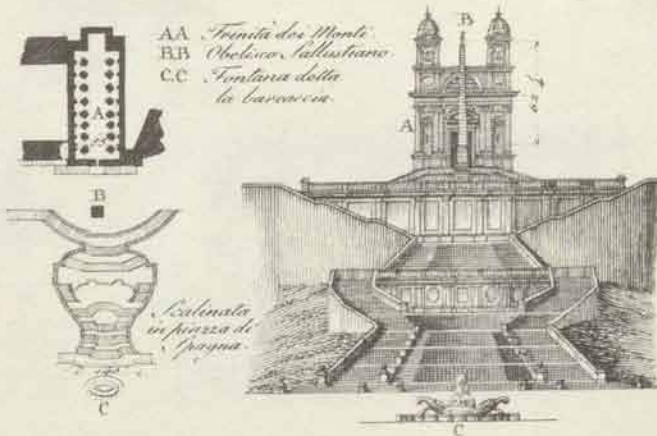

AA Trinità dei Monti
 BB Obelisco, Palladiano
 CC Fontana della
 la barocca

*Scalinate
 in piazza di
 Spagna*



60

Accad. di Francia *Amil. Lippi c. 1550.*



Ingresso in Villa Borghese
Luigi Canina 1828
c. 133



Muro torto



Casamento
Storani.
Carico Colliozzi
vitt. 1533.
di giunte
alla pag. 5.



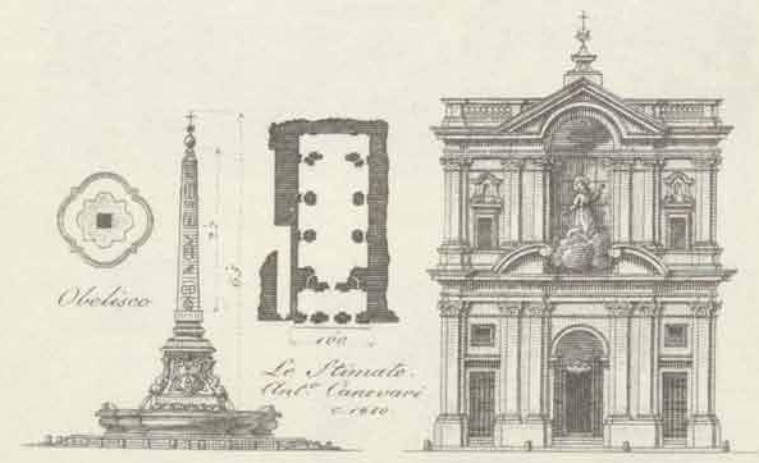
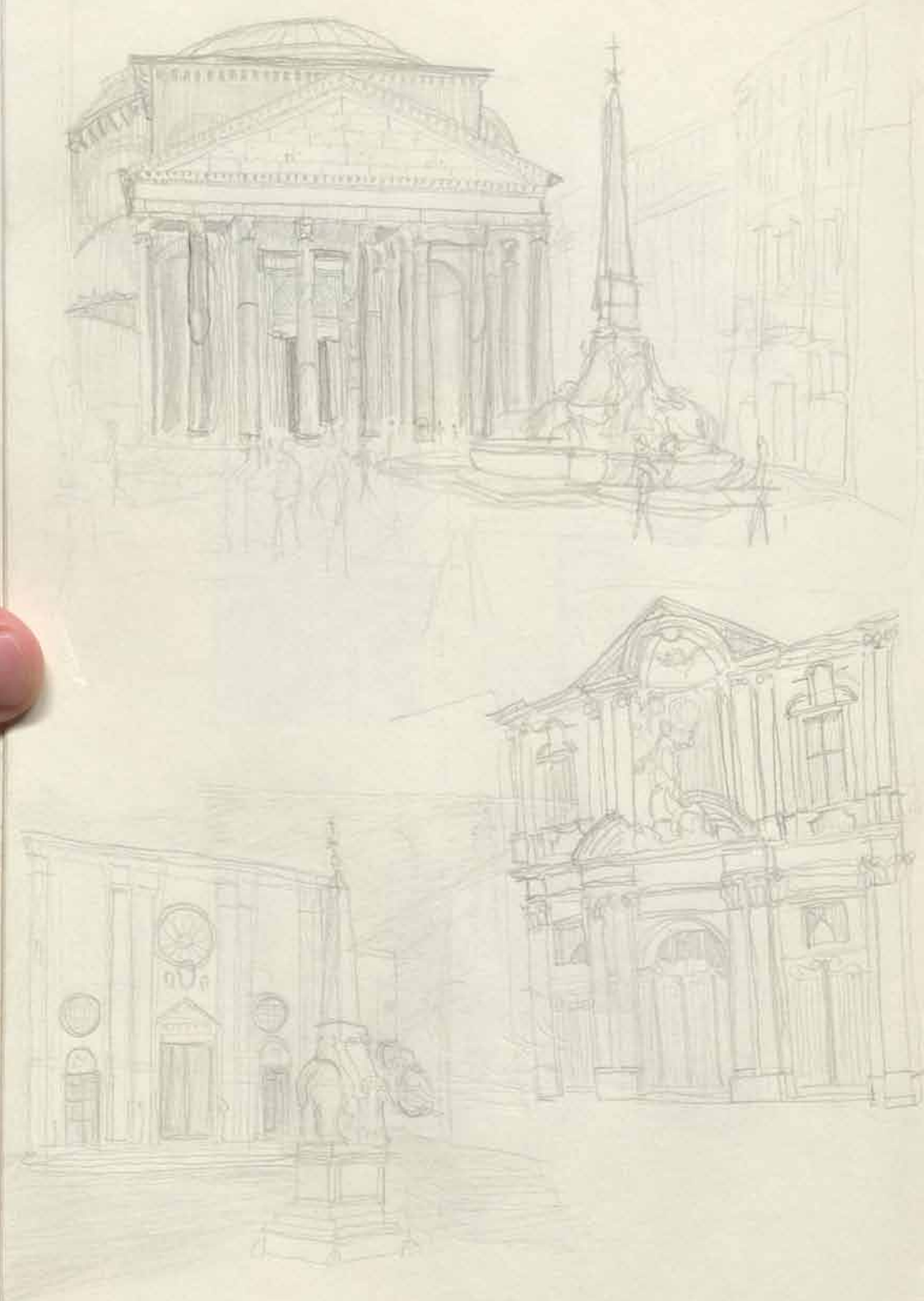



Palaz. Lancellotti

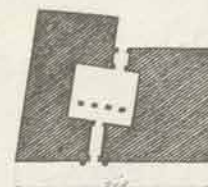

*Tram. de' Volturni
c. 1830.*



*S. Antonio
des Portugueses
Mart. Longhi c. 1830.*

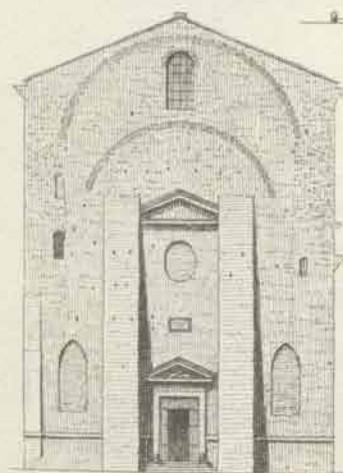

*S. Salvatore in Lauro
Ottavio Mascheroni c. 1830.*

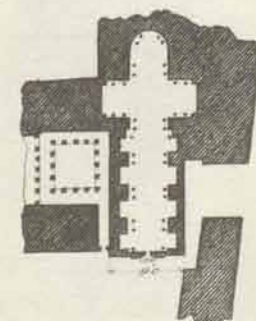



Palaz. Sora
creduto di Bramante
Lazzari
1500

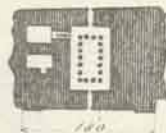

S. M. della Pace
Palaz. da Caprara
1780



S. M. dell'Unione
Bramante
1500

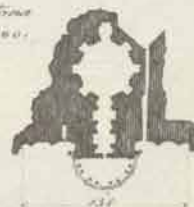

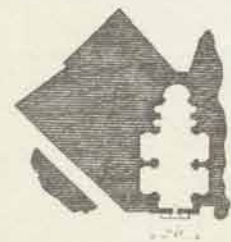
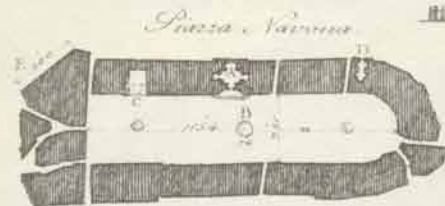
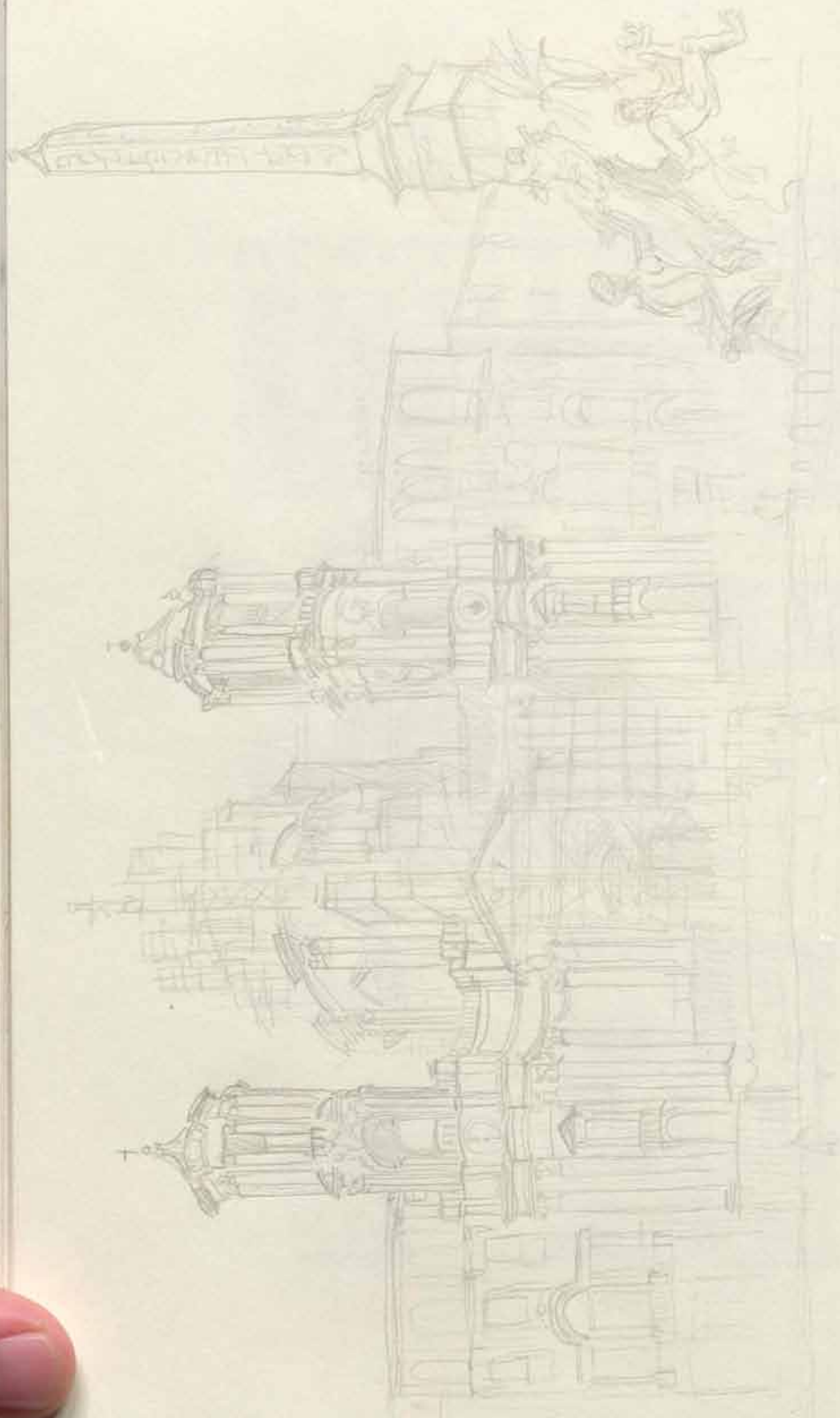

S. Pantaleo
Valadier 1800



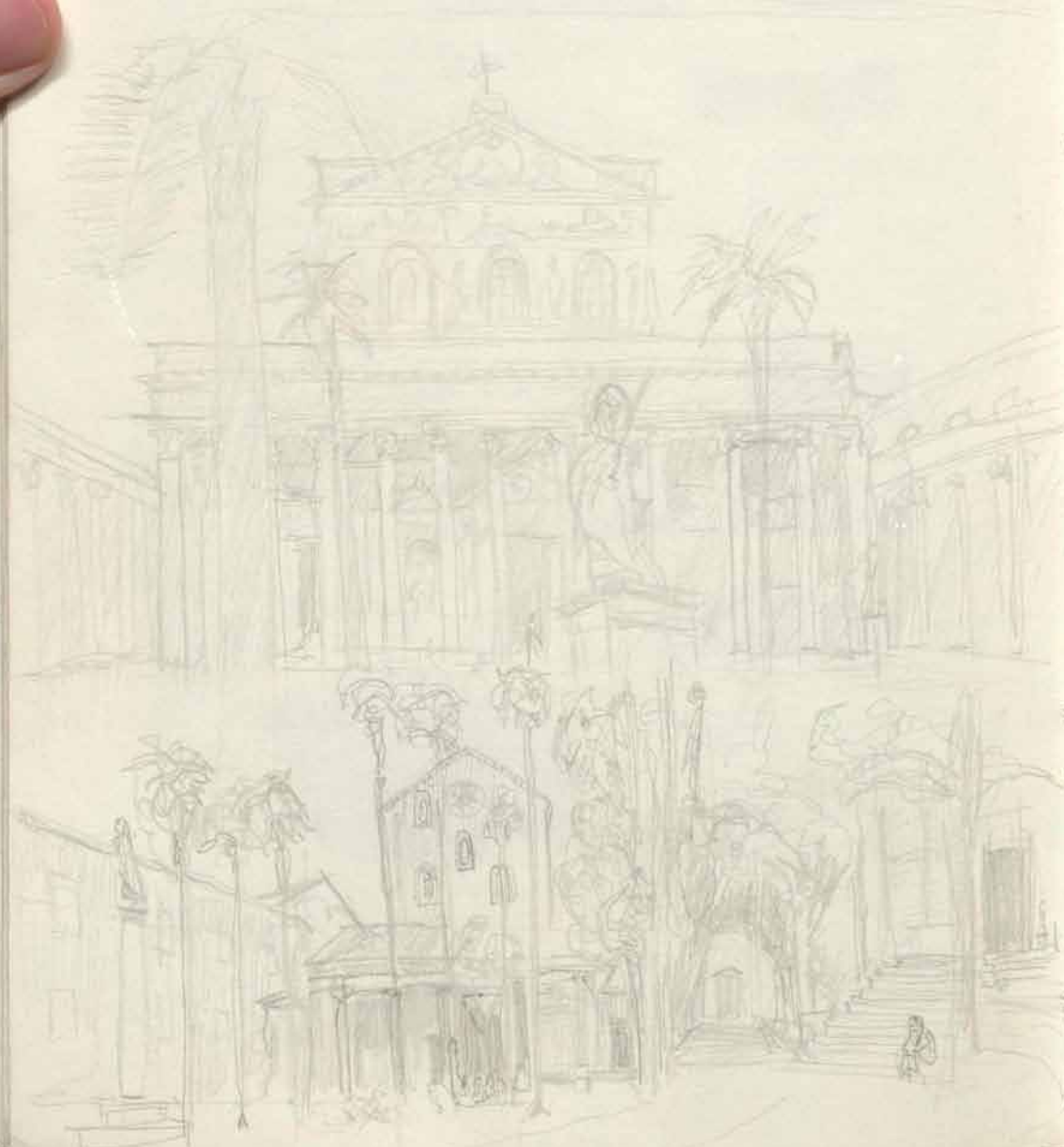

T. del dio redicolo.



Porta S. Paolo



Pyramide di C. Cestio.



Basilica di S. Paolo.



S. M. scalis. G. Cestio. 1522.

Chiesa a S. Paolo alle tre fontane



S. Paolo alle tre fontane. 1521.



S. Anna dei Coltellari



Arco di di Oracio Cocleto



Tempio di Vesta



*S. M.^a
in
Coemeterio
Gius. Sordani
1718.*



Tempio della Fortuna Virile



*Casa di Lala
di Pienza.*



*Ponte
rotto*



S. Salvatore



S. Barbara





SETTIMA GIORNATA

83



*S. Bartolommeo.
M. Longhi*



*S. Gio. Colabita
1600.*



*S. M.
dell'Orto
M. Longhi*

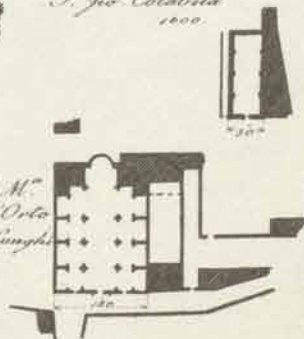

*Palazzo grande ed Ospizio de S. Michele.
Mattea de' Rossi 1600.*

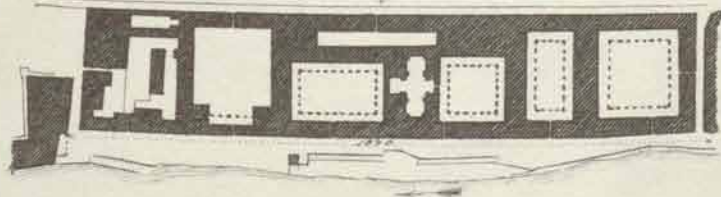

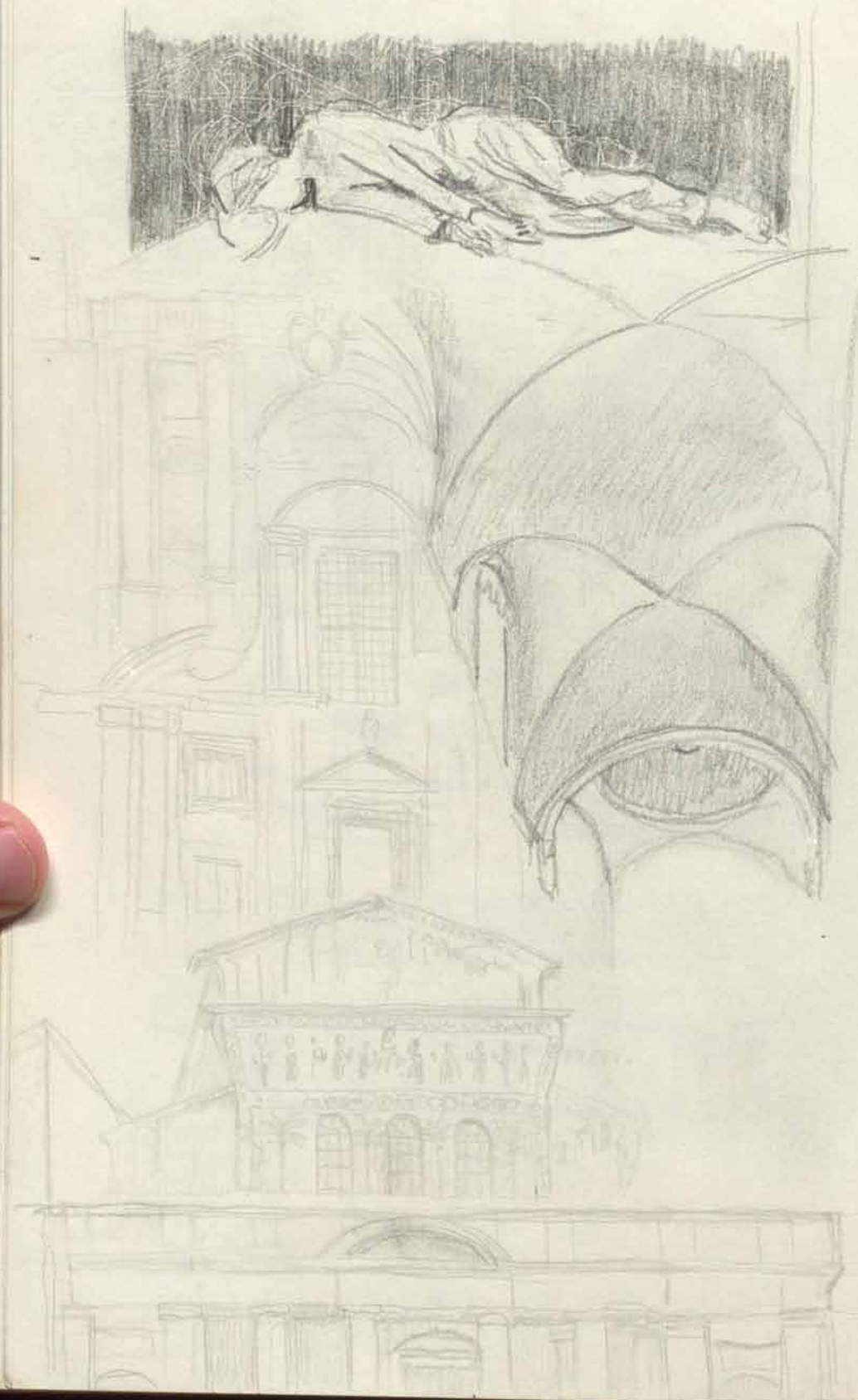

S. Cecilia



Porta Portese



*S. Francesco a Ripa
Matteo de' Rossi
1676*



S. Pasquale

*Giuseppe
Laroli
1744*



*S. N. in
Trastevere*

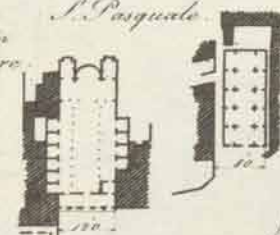

*San Giovanni
in Subura
1623*

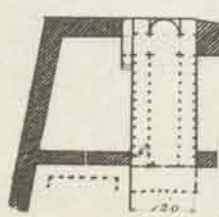



*Ingresso nella Villa
Favilli
Alpi.*



*Casina Corsini. Simone Salvi
c. 1725.*



S. Pancrazio.

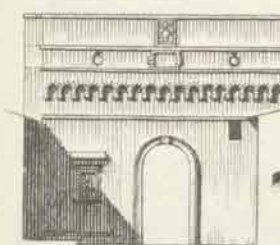
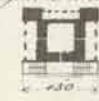

*Porta
Sallustiana.*

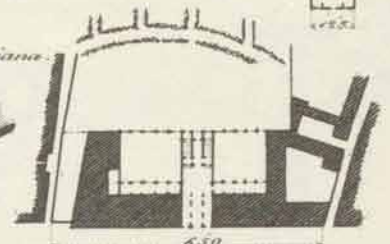

Palazzo Corsini. Ferd. Fuga c. 1755.

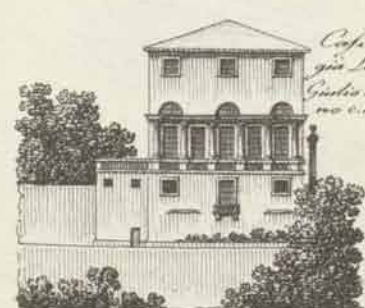

*Casino
gia Lante
Gualdo romano
c. 1580.*

